



VAN NUYS AIRPORT

AIRPORT ADVISORY NOTICE

Notice #2020-024

Date: Wednesday, June 10, 2020

Time: 06:00 am local time

Subject: Runway 16R/34L Shortened Configuration #1 End Date Now Adjusted to June 10, 2020

Weather delays combined with some electrical issues has caused the Taxiway A Rehabilitation Project Work Area 3 end date to extend approximately 10 days.

Runway 16R/34L Shortened Configuration #1 will now end on June 10, 2020.

The current TORA/TODA/ASDA/LDA will also remain in effect until June 10, 2020.

Please see attached Revised Runway 16R/34L Shortened Configuration #1 chart with declared distances for TORA/TODA/ASDS/LDA.

NOTE:

For official NOTAM information, go to <https://pilotweb.nas.faa.gov/PilotWeb/> or contact a Flight Service Specialist at 1-800-WX-Brief (1-800-992-7433).

ADVISORY ISSUED BY	R. Nash
DATE ISSUED	5/20/2020
TIME ISSUED	10:30 AM

For additional information, contact the Van Nuys Airport at (818) 442-6506 or via facsimile at (818) 442-6751

VNY AIRPORT

TWY / RWY CLOSURE MAP

Taxiway A Rehabilitation Project

RUNWAY 16R/34L SHORTENED – Configuration #1

BEGINS APR. 20, 2020 - DURATION 52 DAYS

TWY A Rehab

Shortened Runway Configuration #1

Monday, Apr. 20, 2020 through

June 10, 2020

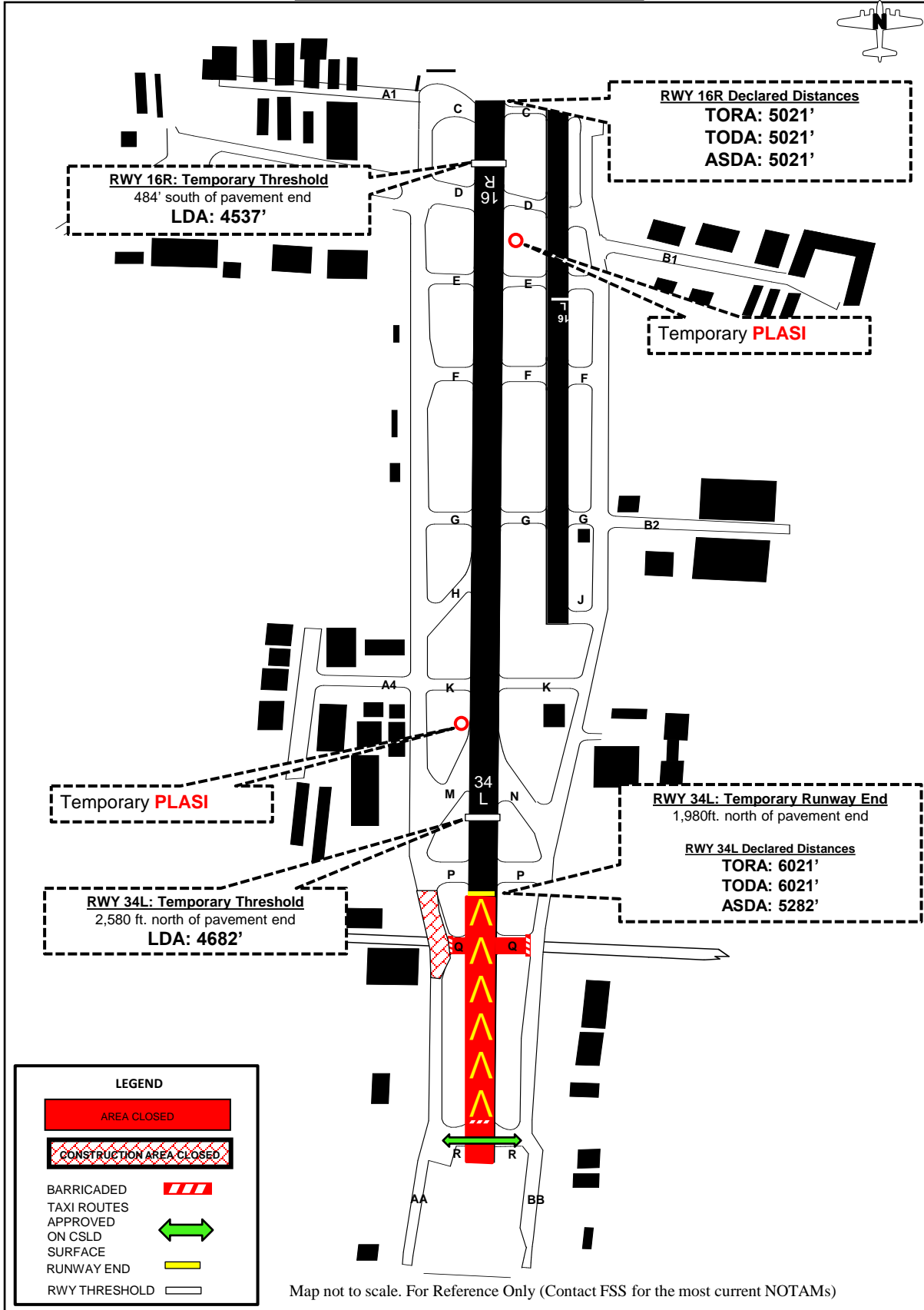

Map not to scale. For Reference Only (Contact FSS for the most current NOTAMS)