



AIRPORT ADVISORY NOTICE

Notice #2020-010

Date: Saturday, April 11, 2020

Time: All hours.

Subject: RWY 16R/34L SHORTENED RUNWAY DECLARED DISTANCES

Runway "16R/34L Shortened" has three configurations, this advisory highlights:

- Taxiway A Rehab Work Area 3 - April 11th through May 24th.
- Runway Configuration #1 – Declared Distances while Work Area 3 is in effect.

Please see the attached diagram showing the closed Taxiway A Rehabilitation Work Area #3 as well as Runway "16R/34L Shortened" declared distances during this phase.

Additional advisories will be issued for Configuration #2 and #3 at a later date.

NOTE:

For official NOTAM information, go to <https://pilotweb.nas.faa.gov/PilotWeb/> or contact a Flight Service Specialist at 1-800-WX-Brief (1-800-992-7433).

ADVISORY ISSUED BY	R. Nash
DATE ISSUED	3/23/2020
TIME ISSUED	12:30 PM

For additional information, contact the Van Nuys Airport at (818) 442-6506 or via facsimile at (818) 442-6751

VNY AIRPORT

TWY / RWY CLOSURE MAP

Taxiway A Rehabilitation Project

RUNWAY 16R/34L SHORTENED – Configuration #1

BEGINS APR. 11, 2020 - DURATION 42 DAYS

TWY A Rehab

Shortened Runway Configuration #1
Saturday, Apr. 11, 2020 – May 24, 2020

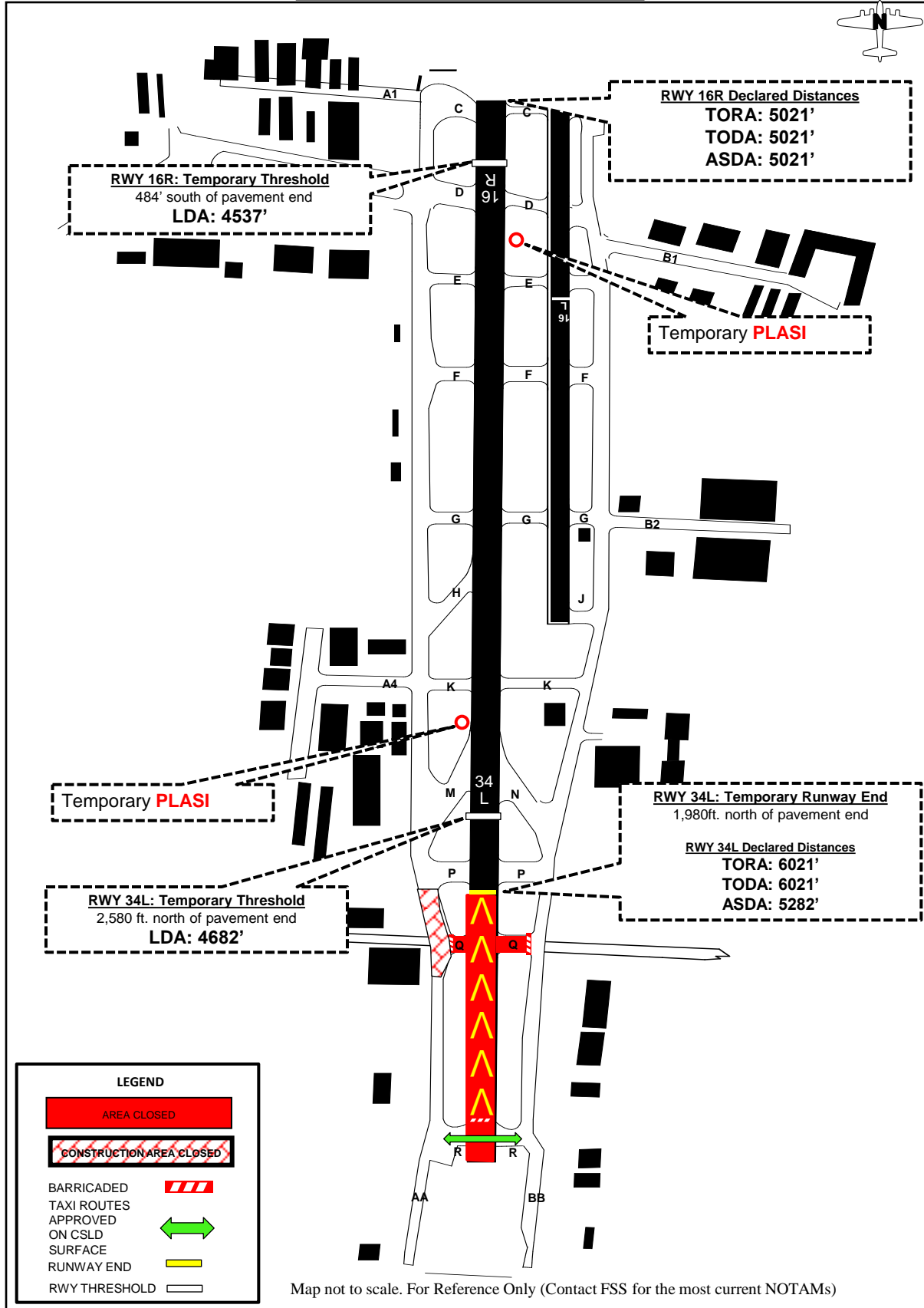

Map not to scale. For Reference Only (Contact FSS for the most current NOTAMS)